

EPDS

EXPAND Control

The EXPAND Control is a purpose-built tablet that serves as either a meeting room controller or a scheduling panel, seamlessly integrating with leading UC solutions for any meeting room. Hassle-free installation and flexible tidy mounting options deliver an intuitive user experience that drives fast deployment and adoption.



red dot winner 2023



Key Features

Enhanced meeting control

The tablet serves as either a meeting room touch controller or scheduling panel which seamlessly integrates with leading UC-solutions, providing a superior meeting experience

Superior user-experience

Designed for an outstanding and ergonomic user experience, the tablet has an optimal viewing angle and a large 10.1" anti-glare treated touch screen

Adapts to all meeting spaces

Suitable for any meeting room size or type, it also supports EPOS EXPAND Vision video conferencing solutions



Flexible and tidy setup

Multiple mounting options, integrated cable retention and a single Power over Ethernet cable ensure an optimal and clean installation

Certified solution

Certified for leading UC solutions including Microsoft Teams Rooms on Android™ and Zoom Rooms, it delivers a flawless user experience and comes with a trusted stamp of approval

What's in the Box



EXPAND Control



Tabletop mount

Quick Guide

Compliance Sheet

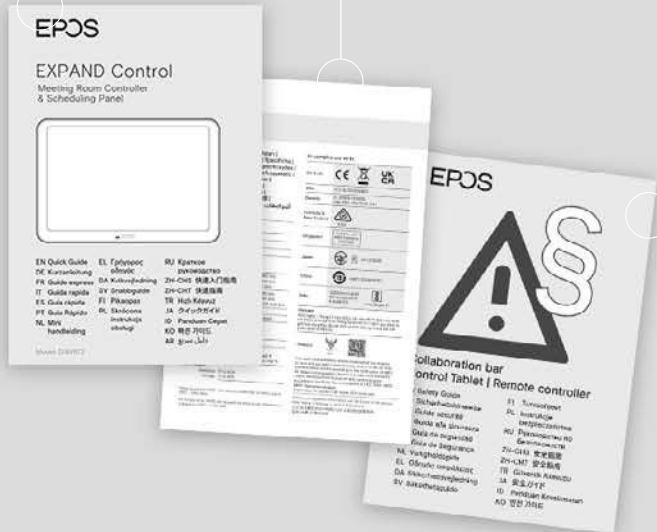

Safety guide

Power over Ethernet (PoE) cable



Additional benefits & features



Secure mounting options

Optional wall and table mounting alternatives allows for flexible placement, Kensington lock support for secure installation



Centralized device management

Remote device administration through EPOS Manager or UC provider solutions



Room bookings, simplified

Side LED-lights clearly indicate room availability – even from a distance



Automatic power saving

Goes into power saving mode when the motion sensor detects no activity in the meeting room



Warranty and support

A two-year warranty ensures your investment is protected. Access to the EPOS Support team for questions and assistance is included

Product data

1/4

General

Color	Black
Weight	1230 g / 43.38 oz
Dimensions	167 x 247 x 104 mm / 6,6 x 9,7 x 4,1 in (H x L x W)
Warranty	2 years. Extended warranty available for purchase

Technical

Operating system	Android™ 10 (or later)
Internal storage	16 GB
CPU	Arm® v8 64-bit 6-core
GPU	Quad Core Arm®
Chipset	Rockchip
RAM memory	4 GB
Supply voltage	36-57V (PoE)
Power consumption	15 W

Product data

2/4

Network & Connectivity

Power over Ethernet (PoE)

IEEE 802.3 af Class 3

Ethernet

IPv4 & IPv6, DHCP / Static IP

Wi-Fi

Dual-band: (2.4 / 5 GHz)
Standard: 802.11ac / 802.11ac

Bluetooth®

Version 5.0
Bluetooth® profiles: A2DP, HSP, AVRCP
Microsoft Teams proximity join

Privacy/Security

Security lock support

Kensington™

Encryption

Hardware encryption (up to 512 bits);
AES encryption (256 bits);
SHA encryption (256 bits);
SecureBoot; SSL traffic encryption

Usability

Display

10.1" LCD touch screen to access call controls and settings

Resolution

1280 x 800

Viewing angle

85, 85, 85, 85 degrees (U / D / L / R)

Positioning/placing angle

36 degrees

Product data

3/4

Products variants

EXPAND Control

EXPAND Vision 5 Bundle

EXPAND Vision 3T Bundle

Software

EPOS devices can be managed with following Software solutions:

EPOS Manager

What's in the box

EPOS EXPAND Control, Power over Ethernet (PoE) cable, Tabletop bottom plate, Safety guide, Quick guide and Compliance sheet

EXPAND Control: EPOS EXPAND Control, Power over Ethernet (PoE) cable, Tabletop bottom plate, Safety guide, Quick guide and Compliance sheet.

EXPAND Vision 5: EPOS EXPAND Vision 5 video bar, Universal power supply, HDMI cable, Wall mount bracket, Safety guide, Quick guide and Compliance sheet

EXPAND Control: EPOS EXPAND Control, Power over Ethernet (PoE) cable, Tabletop bottom plate, Safety guide, Quick guide and Compliance sheet.

EXPAND Vision 3T Core: EPOS EXPAND Vision 3T video bar, Bluetooth® remote control, Universal power supply, USB-C extension cable (5 m/16 ft), HDMI cable, USB-C to USB-A adapter, Wall mount bracket, Safety guide, Quick guide and Compliance sheet.

EXPAND 80T: EXPAND 80T Bluetooth® speakerphone, USB-C cable, BT-D 800 USB dongle, Power supply unit (universal), USB-C to USB-A adapter, Safety guide, Quick guide, Compliance sheet

Manage, update and configure EPOS audio and video devices from any location.

For both cloud and on-premises solutions: eposaudio.com/software-epos-manager

Product data

4/4

Product	Certifications	EAN code	UPC code
EXPAND Control Art. no. 1001072	Certified for leading UC solutions incl. Microsoft Teams Rooms on Android™ and Zoom Rooms	57 14708 00874 3	8 40064 40874 5
EXPAND Vision 5 Bundle Art. no. 1001181	Certified for leading UC solutions incl. Microsoft Teams Rooms on Android™ and Zoom Rooms	57 14708 00985 6	8 40064 40985 8
EXPAND Vision 3T Bundle Art. no. 1001182	Certified for Microsoft Teams Rooms on Android™	57 14708 00986 3	8 40064 40986 5

Spare parts

1/1

Product	Art. no.	Description	EAN code	UPC code
Control - TTM 01	1001155	Tabletop fixture to secure optimal positioning of the EXPAND Control	57 1470800957 3	8 4006440957 5

Accessories

1/1

Product	Price	Art. no.	Description	EAN code	UPC code
Control - WM 01	MSRP: €50 / \$55	1001090	Wall mount for EXPAND Control	57 14708 00892 7	8 40064 40892 9
Control - DM 01	MSRP: €55 / \$60	1001091	Desk mount for EXPAND Control	57 14708 00893 4	8 40064 40893 6
Control WM - G	MSRP: €80 / \$90	1001249	EXPAND Control wall mount for walls where drilling is not possible	57 1470801056 2	8 4006441056 4



Control - WM 01



Control - DM 01

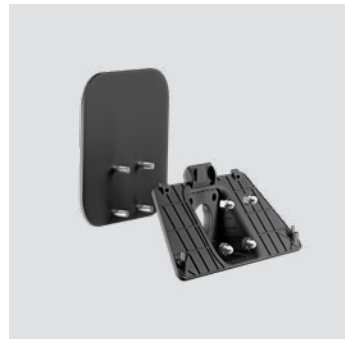

Control WM - G

Appendix

1/1

Additional product data

USB output	5 V, 500 mA
Operating temperature (Max)	65 °C / 149 °F
Operating temperature (Min)	-20 °C / -4 °F
Operating humidity (Max)	90%
Storage temperature (Min)	-40 °C / -40 °F
Storage temperature (Max)	70 °C / 158 °F
Usability	Capacitive touch sensor supports touch functionality
Side-LED	Multi-colored LED indicators
Mounting Options	Designed with integrated table stand (other mounting options available)